

ELEVATION CERTIFICATE

Important: Read the instructions on pages 1-8.

SECTION A - PROPERTY INFORMATION		For Insurance Company Use:
Building Owner's Name TIDAL CONSTRUCTION COMPANY, INC		Policy Number
Building Street Address (including Apt., Unit, Suite, and/or Bldg. No.) or P.O. Route and Box No. #357 BRIGHTON WOODS DRIVE		Company NAIC Number
City POOLER State GA ZIP Code 31322		

A3. Property Description (Lot and Block Numbers, Tax Parcel Number, Legal Description, etc.)
LOT 5 THE GROVE AT BRIGHTON WOODS

A4. Building Use (e.g., Residential, Non-Residential, Addition, Accessory, etc.) RESIDENTIAL

A5. Latitude/Longitude: Lat. N 32° 06' 57.1" Long. W 81° 15' 45.5"

Horizontal Datum: NAD 1927 NAD 1983

A6. Attach at least 2 photographs of the building if the Certificate is being used to obtain flood insurance.

A7. Building Diagram Number 1

A8. For a building with a crawl space or enclosure(s), provide

- a) Square footage of crawl space or enclosure(s) 0 sq ft
- b) No. of permanent flood openings in the crawl space or enclosure(s) walls within 1.0 foot above adjacent grade 0
- c) Total net area of flood openings in A8.b 0 sq in

A9. For a building with an attached garage, provide:

- a) Square footage of attached garage 473 sq ft
- b) No. of permanent flood openings in the attached garage walls within 1.0 foot above adjacent grade 0
- c) Total net area of flood openings in A9.b 0 sq in

SECTION B - FLOOD INSURANCE RATE MAP (FIRM) INFORMATION

B1. NFIP Community Name & Community Number CITY OF POOLER 130261		B2. County Name CHATHAM (INCORPORATED)		B3. State GA	
B4. Map/Panel Number 130261 0001	B5. Suffix A	B6. FIRM Index Date 09/30/81	B7. FIRM Panel Effective/Revised Date 09/30/81	B8. Flood Zone(s) A5	B9. Base Flood Elevation(s) (Zone AO, use base flood depth) 16.0

B10. Indicate the source of the Base Flood Elevation (BFE) data or base flood depth entered in Item B9.

- FIS Profile FIRM Community Determined Other (Describe) _____

B11. Indicate elevation datum used for BFE in Item B9: NGVD 1929 NAVD 1988 Other (Describe) _____

B12. Is the building located in a Coastal Barrier Resources System (CBRS) area or Otherwise Protected Area (OPA)? Yes No
Designation Date _____ CBRS OPA

SECTION C - BUILDING ELEVATION INFORMATION (SURVEY REQUIRED)

Building elevations are based on: Construction Drawings* Building Under Construction* Finished Construction
*A new Elevation Certificate will be required when construction of the building is complete.

C2. Elevations - Zones A1-A30, AE, AH, A (with BFE), VE, V1-V30, V (with BFE), AR, ARIA, ARIA/E, ARIA1-A30, ARIA/H, ARIA/O. Complete items C2.a-g below according to the building diagram specified in item A7.

Benchmark Utilized 18.03 Vertical Datum NGVD 1929

Conversion/Comments NONE

Check the measurement used.

- a) Top of bottom floor (including basement, crawl space, or enclosure floor) 18.3 feet meters (Puerto Rico only)
- b) Top of the next higher floor 28.8 feet meters (Puerto Rico only)
- c) Bottom of the lowest horizontal structural member (V Zones only) N/A feet meters (Puerto Rico only)
- d) Attached garage (top of slab) 17.3 feet meters (Puerto Rico only)
- e) Lowest elevation of machinery or equipment servicing the building (Describe type of equipment in Comments) 17.0 feet meters (Puerto Rico only)
- f) Lowest adjacent (finished) grade (LAG) 16.6 feet meters (Puerto Rico only)
- g) Highest adjacent (finished) grade (HAG) 16.9 feet meters (Puerto Rico only)

SECTION D - SURVEYOR, ENGINEER, OR ARCHITECT CERTIFICATION

This certification is to be signed and sealed by a land surveyor, engineer, or architect authorized by law to certify elevation information. I certify that the information on this Certificate represents my best efforts to interpret the data available. I understand that any false statement may be punishable by fine or imprisonment under 18 U.S. Code, Section 1001.

Check here if comments are provided on back of form.

Certifier's Name	DAVID A. BRUNSON	License Number	2538
Title	REGISTERED LAND SURVEYOR	Company Name	SOUTHEAST GEORGIA SURVEYING & MAPPING
Address	518 EDSEL DRIVE SUITE D	City	RICHMOND HILL State GA ZIP Code 31324
Signature		Date	07/24/07 Telephone 912-756-2211

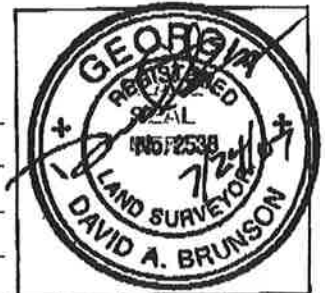

IMPORTANT: In these spaces, copy the corresponding information from Section A.	For Insurance Company Use:
Building Street Address (Including Apt., Unit, Suite, and/or Bldg. No.) or P.O. Route and Box No. #357 BRIGHTON WOODS DRIVE	Policy Number
City POOLER State GA ZIP Code 31322	Company NAIC Number

SECTION D - SURVEYOR, ENGINEER, OR ARCHITECT CERTIFICATION (CONTINUED)

Copy both sides of this Elevation Certificate for (1) community official, (2) insurance agent/company, and (3) building owner.

Comments JOB #06-107 LOT 5 THE GROVE AT BRIGHTON WOODS. C2e -THE LOWEST SERVICING EQUIPMENT IS AN AIR CONDITIONING UNIT.

Signature  Date 07/24/07 Check here if attachments

SECTION E - BUILDING ELEVATION INFORMATION (SURVEY NOT REQUIRED) FOR ZONE AO AND ZONE A (WITHOUT BFE)

For Zones AO and A (without BFE), complete items E1-E5. If the Certificate is intended to support a LOMA or LOMR-F request, complete Sections A, B, and C. For items E1-E4, use natural grade, if available. Check the measurement used. In Puerto Rico only, enter meters.

- E1. Provide elevation information for the following and check the appropriate boxes to show whether the elevation is above or below the highest adjacent grade (HAG) and the lowest adjacent grade (LAG).
 - a) Top of bottom floor (including basement, crawl space, or enclosure) is N/A feet meters above or below the HAG.
 - b) Top of bottom floor (including basement, crawl space, or enclosure) is _____ feet meters above or below the LAG.
- E2. For Building Diagrams 6-8 with permanent flood openings provided in Section A Items 8 and/or 9 (see page 6 of instructions), the next higher floor (elevation C2.b in the diagrams) of the building is _____ feet meters above or below the HAG.
- E3. Attached garage (top of slab) is _____ feet meters above or below the HAG.
- E4. Top of platform of machinery and/or equipment servicing the building is _____ feet meters above or below the HAG.
- E5. Zone AO only: If no flood depth number is available, is the top of the bottom floor elevated in accordance with the community's floodplain management ordinance? Yes No Unknown. The local official must certify this information in Section G.

SECTION F - PROPERTY OWNER (OR OWNER'S REPRESENTATIVE) CERTIFICATION

The property owner or owner's authorized representative who completes Sections A, B, and E for Zone A (without a FEMA-issued or community-issued BFE) or Zone AO must sign here. The statements in Sections A, B, and E are correct to the best of my knowledge.

Property Owner's or Owner's Authorized Representative's Name _____

Address N/A City _____ State _____ ZIP Code _____

Signature _____ Date _____ Telephone _____

Comments _____ Check here if attachments

SECTION G - COMMUNITY INFORMATION (OPTIONAL)

The local official who is authorized by law or ordinance to administer the community's floodplain management ordinance can complete Sections A, B, C (or E), and G of this Elevation Certificate. Complete the applicable item(s) and sign below. Check the measurement used in items G8, and G9.

- G1. The information in Section C was taken from other documentation that has been signed and sealed by a licensed surveyor, engineer, or architect who is authorized by law to certify elevation information. (Indicate the source and date of the elevation data in the Comments area below.)
- G2. A community official completed Section E for a building located in Zone A (without a FEMA-issued or community-issued BFE) or Zone AO.
- G3. The following information (items G4.-G9.) is provided for community floodplain management purposes.

G4. Permit Number	G5. Date Permit issued	G6. Date Certificate Of Compliance/Occupancy Issued
-------------------	------------------------	---

- G7. This permit has been issued for: New Construction Substantial Improvement
- G8. Elevation of as-built lowest floor (including basement) of the building: _____ feet meters (PR) Datum _____
- G9. BFE or (in Zone AO) depth of flooding at the building site: _____ feet meters (PR) Datum _____

Local Official's Name N/A Title _____

Community Name _____ Telephone _____

Signature _____ Date _____

Comments _____ Check here if attachments

Building Photographs

See Instructions for Item A6.

Building Street Address (including Apt., Unit, Suite, and/or Bldg. No.) or P.O. Route and Box No. #357 BRIGHTON WOODS DRIVE	For Insurance Company Use: Policy Number
City POOLER State GA ZIP Code 31322	Company NAIC Number
If using the Elevation Certificate to obtain NFIP flood insurance, affix at least two building photographs below according to the instructions for Item A6. Identify all photographs with: date taken; "Front View" and "Rear View"; and, if required, "Right Side View" and "Left Side View." If submitting more photographs than will fit on this page, use the Continuation Page, following.	

FRONT VIEW 0719/07

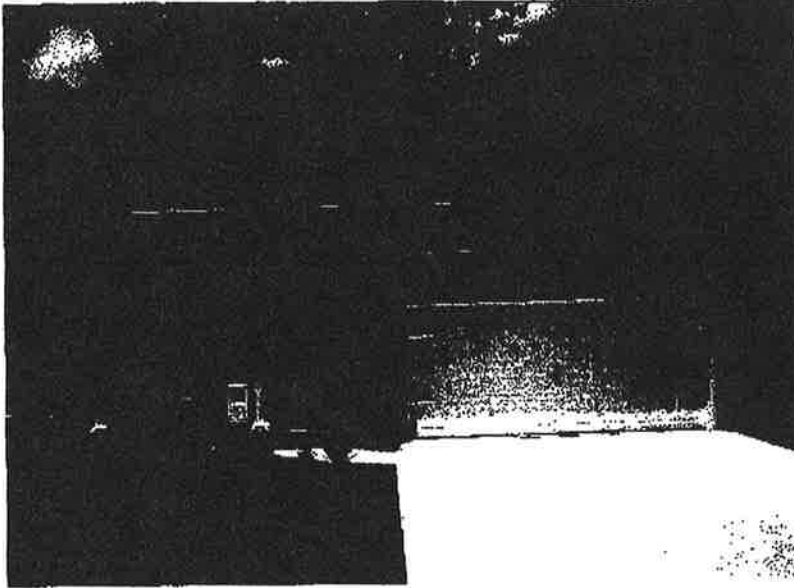

REAR VIEW 0719/07

