

# ELEVATION CERTIFICATE

**Important: Read the instructions on pages 1 - 7.**

SECTION A - PROPERTY OWNER INFORMATION			For Insurance Company Use:	
BUILDING OWNER'S NAME <i>Diana Mydell</i>			Policy Number	
BUILDING STREET ADDRESS (Including Apt., Unit, Suite, and/or Bldg. No.) OR P.O. ROUTE AND BOX NO. <b>Lot 195 Hunters Ridge - Phase 4B</b> <b>No. 267 Longleaf Circle</b>			Company NAIC Number	
CITY <b>Pooler</b>	STATE <b>GA</b>	ZIP CODE <b>31322</b>		
PROPERTY DESCRIPTION (Lot and Block Numbers, Tax Parcel Number, Legal Description, etc.) <b>Lot 195 Hunters Ridge - Phase 4B</b>				
BUILDING USE (e.g., Residential, Non-residential, Addition, Accessory, etc. Use Comments section if necessary.) <b>Residential</b>				
LATITUDE/LONGITUDE (OPTIONAL) (###-##-### or #####)		HORIZONTAL DATUM: <input type="checkbox"/> NAD 1927 <input type="checkbox"/> NAD 1983		SOURCE: <input type="checkbox"/> GPS (Type): <input type="checkbox"/> USGS Quad Map <input type="checkbox"/> Other: _____

## SECTION B - FLOOD INSURANCE RATE MAP (FIRM) INFORMATION

B1. NFIP COMMUNITY NAME & COMMUNITY NUMBER <b>130261 Pooler</b>		B2. COUNTY NAME <b>Chatham</b>		B3. STATE <b>GA</b>	
B4. MAP AND PANEL NUMBER <b>130030 0075</b>	B5. SUFFIX <b>C</b>	B6. FIRM INDEX DATE <b>9/20/95</b>	B7. FIRM PANEL EFFECTIVE/REVISED DATE <b>9/3/92</b>	B8. FLOOD ZONE(S) <b>AE</b>	B9. BASE FLOOD ELEVATION(S) (Zone AO, use depth of flooding) <b>12.0</b>

B10. Indicate the source of the Base Flood Elevation (BFE) data or base flood depth entered in B9.  
 FIS Profile  FIRM  Community Determined  Other (Describe): \_\_\_\_\_

B11. Indicate the elevation datum used for the BFE in B9:  NGVD 1929  NAVD 1988  Other (Describe): \_\_\_\_\_

B12. Is the building located in a Coastal Barrier Resources System (CBRS) area or Otherwise Protected Area (OPA)?  Yes  No Designation Date \_\_\_\_\_

## SECTION C - BUILDING ELEVATION INFORMATION (SURVEY REQUIRED)

C1. Building elevations are based on:  Construction Drawings\*  Building Under Construction\*  Finished Construction

\*A new Elevation Certificate will be required when construction of the building is complete.

C2. Building Diagram Number 1 (Select the building diagram most similar to the building for which this certificate is being completed - see pages 6 and 7. If no diagram accurately represents the building, provide a sketch or photograph.)

C3. Elevations - Zones A1-A30, AE, AH, A (with BFE), VE, V1-V30, V (with BFE), AR, AR/A, AR/AE, AR/A1-A30, AR/AH, AR/AO  
 Complete Items C3a-i below according to the building diagram specified in Item C2. State the datum used. If the datum is different from the datum used for the BFE in Section B, convert the datum to that used for the BFE. Show field measurements and datum conversion calculation. Use the space provided or the Comments area of Section D or Section G, as appropriate, to document the datum conversion.  
 Datum \_\_\_\_\_ Conversion/Comments \_\_\_\_\_

Elevation reference mark used \_\_\_\_\_ Does the elevation reference mark used appear on the FIRM?  Yes  No

a) Top of bottom floor (including basement or enclosure) **21.1 ft.(m)**

b) Top of next higher floor \_\_\_\_\_ ft.(m)

c) Bottom of lowest horizontal structural member (V zones only) \_\_\_\_\_ ft.(m)

d) Attached garage (top of slab) **20.6 ft.(m)**

e) Lowest elevation of machinery and/or equipment servicing the building \_\_\_\_\_ ft.(m)

f) Lowest adjacent grade (LAG) **19.8 ft.(m)**

g) Highest adjacent grade (HAG) **20.0 ft.(m)**

h) No. of permanent openings (flood vents) within 1 ft. above adjacent grade \_\_\_\_\_

i) Total area of all permanent openings (flood vents) in C3h \_\_\_\_\_ sq. in. (sq. cm)

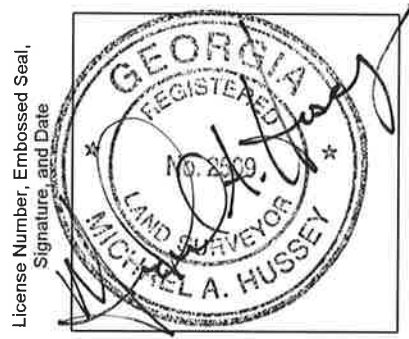

## SECTION D - SURVEYOR, ENGINEER, OR ARCHITECT CERTIFICATION

This certification is to be signed and sealed by a land surveyor, engineer, or architect authorized by law to certify elevation information.  
 I certify that the information in Sections A, B, and C on this certificate represents my best efforts to interpret the data available.  
 I understand that any false statement may be punishable by fine or imprisonment under 18 U.S. Code, Section 1001.

CERTIFIER'S NAME **Michael A. Hussey** LICENSE NUMBER **2509**

TITLE **Land Surveyor** COMPANY NAME **Stevenson & Palmer Engineering, Inc**

ADDRESS **P.O. Box 15845** CITY **Savannah** STATE **GA** ZIP CODE **31416**

SIGNATURE *[Signature]* DATE **5/15/00** TELEPHONE **912-355-9603**



15/4/4

<b>IMPORTANT: In these spaces, copy the corresponding information from Section A.</b>			For Insurance Company Use:
BUILDING STREET ADDRESS (Including Apt., Unit, Suite, and/or Bldg. No.) OR P.O. ROUTE AND BOX NO. <b>No. 267 Longleaf Circle</b>			Policy Number
CITY Pooler	STATE GA	ZIP CODE 31322	Company NAIC Number

**SECTION D - SURVEYOR, ENGINEER, OR ARCHITECT CERTIFICATION (CONTINUED)**

Copy both sides of this Elevation Certificate for (1) community official, (2) insurance agent/company, and (3) building owner.

COMMENTS

Check here if attachments

**SECTION E - BUILDING ELEVATION INFORMATION (SURVEY NOT REQUIRED) FOR ZONE AO AND ZONE A (WITHOUT BFE)**

For Zone AO and Zone A (without BFE), complete Items E1 through E4. *If the Elevation Certificate is intended for use as supporting information for a LOMA or LOMR-F, Section C must be completed.*

- E1. Building Diagram Number \_\_ (Select the building diagram most similar to the building for which this certificate is being completed – see pages 6 and 7. If no diagram accurately represents the building, provide a sketch or photograph.)
- E2. The top of the bottom floor (including basement or enclosure) of the building is \_\_ ft.(m) \_\_ in.(cm)  above or  below (check one) the highest adjacent grade.
- E3. For Building Diagrams 6-8 with openings (see page 7), the next higher floor or elevated floor (elevation b) of the building is \_\_ ft.(m) \_\_ in.(cm) above the highest adjacent grade.
- E4. For Zone AO only: If no flood depth number is available, is the top of the bottom floor elevated in accordance with the community's floodplain management ordinance?  
 Yes  No  Unknown. The local official must certify this information in Section G.

**SECTION F - PROPERTY OWNER (OR OWNER'S REPRESENTATIVE) CERTIFICATION**

The property owner or owner's authorized representative who completes Sections A, B, and E for Zone A (without a FEMA-issued or community-issued BFE) or Zone AO must sign here.

PROPERTY OWNER'S OR OWNER'S AUTHORIZED REPRESENTATIVE'S NAME

ADDRESS	CITY	STATE	ZIP CODE
SIGNATURE	DATE	TELEPHONE	

COMMENTS

Check here if attachments

**SECTION G - COMMUNITY INFORMATION (OPTIONAL)**

The local official who is authorized by law or ordinance to administer the community's floodplain management ordinance can complete Sections A, B, C (or E), and G of this Elevation Certificate. Complete the applicable item(s) and sign below.

- G1.  The information in Section C was taken from other documentation that has been signed and embossed by a licensed surveyor, engineer, or architect who is authorized by state or local law to certify elevation information. (Indicate the source and date of the elevation data in the Comments area below.)
- G2.  A community official completed Section E for a building located in Zone A (without a FEMA-issued or community-issued BFE) or Zone AO.
- G3.  The following information (Items G4-G9) is provided for community floodplain management purposes.

G4. PERMIT NUMBER	G5. DATE PERMIT ISSUED	G6. DATE CERTIFICATE OF COMPLIANCE/OCCUPANCY ISSUED
-------------------	------------------------	---

- G7. This permit has been issued for:  New Construction  Substantial Improvement
- G8. Elevation of as-built lowest floor (including basement) of the building is: \_\_\_\_\_ ft.(m) Datum: \_\_\_\_\_
- G9. BFE or (in Zone AO) depth of flooding at the building site is: \_\_\_\_\_ ft.(m) Datum: \_\_\_\_\_

LOCAL OFFICIAL'S NAME	TITLE
COMMUNITY NAME	TELEPHONE
SIGNATURE	DATE

COMMENTS

Check here if attachments

