

# FEDERAL EMERGENCY MANAGEMENT AGENCY NATIONAL FLOOD INSURANCE PROGRAM ELEVATION CERTIFICATE

O.M.B. No. 3067-0077  
Expires December 31, 2005

Important: Read the instructions on pages 1 - 7.

## SECTION A - PROPERTY OWNER INFORMATION

BUILDING OWNER'S NAME <b>2195 Group</b>	PROPERTY DESCRIPTION (Lot and Block Numbers, Tax Parcel Number, Legal Description, etc.) <b>LOT 19 WEST SIDE BUSINESS PARK</b>	Flood Insurance Company Use Policy Number Company NAIC Number
BUILDING STREET ADDRESS (Including Apt., Unit, Suite, and/or Bldg. No.) OR P.O. ROUTE AND BOX NO. <b>87 COLUMBIA DRIVE</b>	CITY <b>POOLER</b>	STATE <b>GA.</b>
CITY	STATE	ZIP CODE <b>31322</b>
BUILDING USE (e.g., Residential, Non-residential, Addition, Accessory, etc. Use a Comments area, if necessary.) <b>NON-RESIDENTIAL</b>		
LATITUDE/LONGITUDE (OPTIONAL) (##°-##'-##"##" or ##.####")		
HORIZONTAL DATUM: <input checked="" type="checkbox"/> NAD 1927 <input type="checkbox"/> NAD 1983		SOURCE: <input type="checkbox"/> GPS (Type): <input type="checkbox"/> USGS Quad Map <input type="checkbox"/> Other

## SECTION B - FLOOD INSURANCE RATE MAP (FIRM) INFORMATION

B1. NFIP COMMUNITY NAME & COMMUNITY NUMBER <b>CHATHAM COUNTY</b>	B2. COUNTY NAME <b>CHATHAM</b>	B3. STATE <b>GEORGIA</b>
B4. MAP AND PANEL NUMBER <b>130030 003D</b>	B5. SUFFIX <b>C</b>	B6. FIRM INDEX DATE <b>MAY 19, 1987</b>
B7. FIRM PANEL EFFECTIVE/REVISED DATE	B8. FLOOD ZONE(S) <b>AE</b>	B9. BASE FLOOD ELEVATION(S) (Zone AO, use depth of flooding) <b>14.0</b>

B10. Indicate the source of the Base Flood Elevation (BFE) data or base flood depth entered in B9.  
 FIS Profile     FIRM     Community Determined     Other (Describe): \_\_\_\_\_

B11. Indicate the elevation datum used for the BFE in B9:  NGVD 1929     NAVD 1988     Other (Describe): \_\_\_\_\_

B12. Is the building located in a Coastal Barrier Resources System (CBRS) area or Otherwise Protected Area (OPA)?  Yes     No  
 Designation Date: \_\_\_\_\_

## SECTION C - BUILDING ELEVATION INFORMATION (SURVEY REQUIRED)

C1. Building elevations are based on:  Construction Drawings\*     Building Under Construction\*     Finished Construction  
 \*A new Elevation Certificate will be required when construction of the building is complete.

C2. Building Diagram Number   1   (Select the building diagram most similar to the building for which this certificate is being completed - see pages 6 and 7. If no diagram accurately represents the building, provide a sketch or photograph.)

C3. Elevations - Zones A1-A30, AE, AH, A (with BFE), VE, V1-V30, V (with BFE), AR, AR/A, AR/AE, AR/A1-A30, AR/AH, AR/AO  
 Complete Items C3.a-i below according to the building diagram specified in Item C2. State the datum used. If the datum is different from the datum used for the BFE in Section B, convert the datum to that used for the BFE. Show field measurements and datum conversion calculation. Use the space provided or the Comments area of Section D or Section G, as appropriate, to document the datum conversion.  
 Datum 1929    Conversion/Comments \_\_\_\_\_

Elevation reference mark used \_\_\_\_\_ Does the elevation reference mark used appear on the FIRM?  Yes     No

<input type="checkbox"/> a) Top of bottom floor (including basement or enclosure)	_____	<u>15.92</u> ft. (m)
<input type="checkbox"/> b) Top of next higher floor	_____	<u>N/A</u> ft. (m)
<input type="checkbox"/> c) Bottom of lowest horizontal structural member (V zones only)	_____	<u>N/A</u> ft. (m)
<input type="checkbox"/> d) Attached garage (top of slab)	_____	<u>N/A</u> ft. (m)
<input type="checkbox"/> e) Lowest elevation of machinery and/or equipment servicing the building (Describe in a Comments area.)	_____	<u>N/A</u> ft. (m)
<input type="checkbox"/> f) Lowest adjacent (finished) grade (LAG)	_____	<u>12.70</u> ft. (m)
<input type="checkbox"/> g) Highest adjacent (finished) grade (HAG)	_____	<u>15.30</u> ft. (m)
<input type="checkbox"/> h) No. of permanent openings (flood vents) within 1 ft. above adjacent grade	_____	<u>N/A</u>
<input type="checkbox"/> i) Total area of all permanent openings (flood vents) in C3.h	_____	<u>N/A</u> sq. in. (sq. cm)

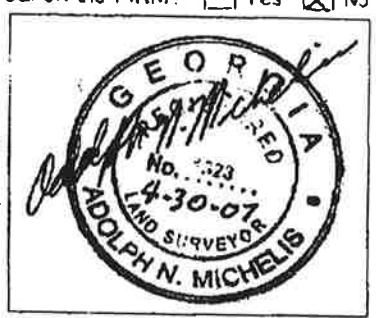

## SECTION D - SURVEYOR, ENGINEER, OR ARCHITECT CERTIFICATION

This certification is to be signed and sealed by a land surveyor, engineer, or architect authorized by law to certify elevation information.  
 I certify that the information in Sections A, B, and C on this certificate represents my best efforts to interpret the data available  
 I understand that any false statement may be punishable by fine or imprisonment under 18 U.S. Code, Section 1001.

CERTIFIER'S NAME: **ADOLPH N. MICHELIS**    LICENSE NUMBER: **1323**

TITLE: **REGISTERED LAND SURVEYOR**    COMPANY NAME: \_\_\_\_\_

ADDRESS: **736 SANDY RIDGE ROAD**    CITY: **SYLVANIA**    STATE: **GA**    ZIP CODE: **30467**

SIGNATURE: *Adolph N. Michelis*    DATE: **4-30-07**    TELEPHONE: **912 829 3972**

